

# Installation Guide

- 5 Insert the frame into prepared structural opening and pack as necessary to ensure that the frame is held plumb and square inside the opening.

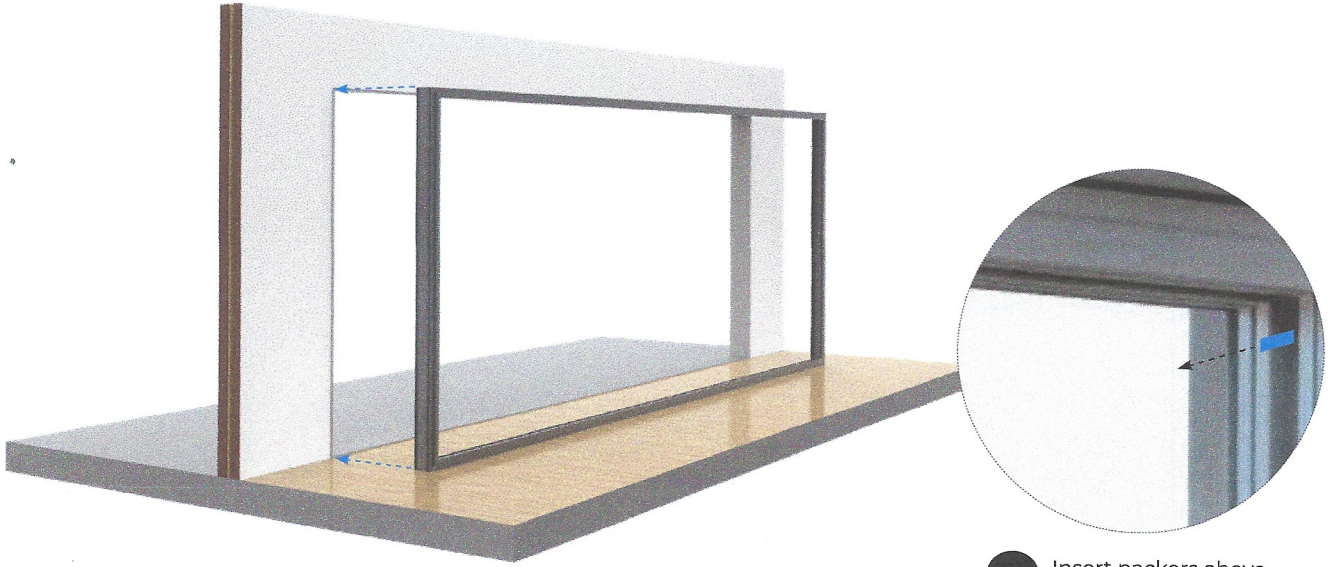

5.1 Insert packers above both jambs.

The recommended separation between screws should not exceed 500 mm. The depth of the fastening on site should never be less than 30 mm. (See table with recommendations for use)

## ESQUEMA DE COLCACIÓN EN OBRA

### SITE INSTALLATION SCHEME

#### Profundidad mínima del tornillo

#### Minimum screw depth

Material mm. 20 30 40 50 60

Material	mm. 20	30	40	50	60
LADRILLO HUECO (2 paredes) HOLLOW BRICK (2 walls)	40	50	50	50	50
MADERA U HORMIGÓN LIGERO WOOD AND LIGHTWEIGHT CONCRETE	30	30	30	30	30
PIEDRA STONE	40	40	40	40	40
LADRILLO MACIZO SOLID BRICK	30	30	30	30	30
PARED MACIZA SOLID WALL	30	30	30	30	30
HORMIGÓN CONCRETE	30	30	30	30	30

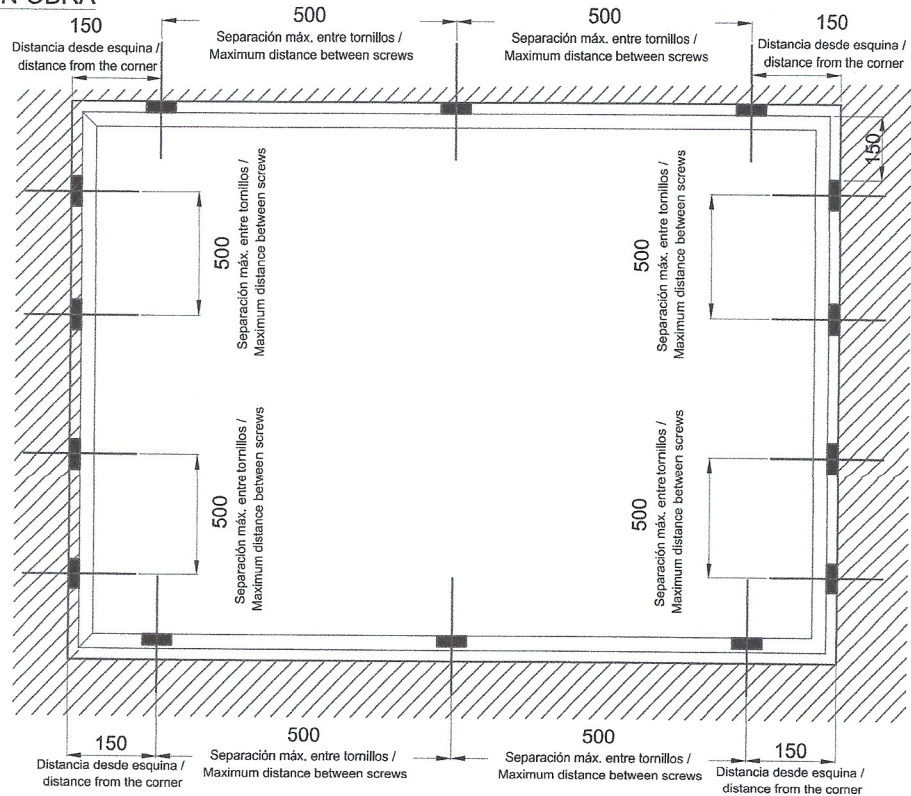

## Installation Guide

! Frame screws are positioned as shown below:

Inward opening

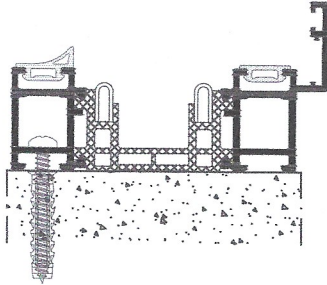

Outward opening

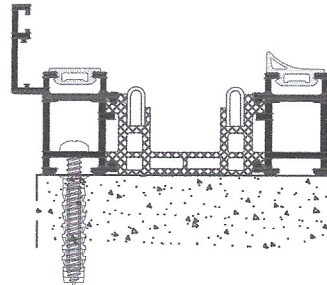

5.2 Pack out jambs accordingly when level.



5.3 Pack out across the top track for consistent internal frame sizes. Ensure the track doesn't bow in any direction. Ensure that the building does not transmit any loads into the frame.

## Installation Guide

---

- 6 Level out jambs in both directions and fix them.



- 7 Fix the top track. Where possible, fixing points should be on both sides of the frame, in a zig-zag pattern.



## Installation Guide

---

- 7.1** Drill and countersink an appropriate sized fixing hole through the frame. This should be no more than 200 mm from the external corner of the frame.

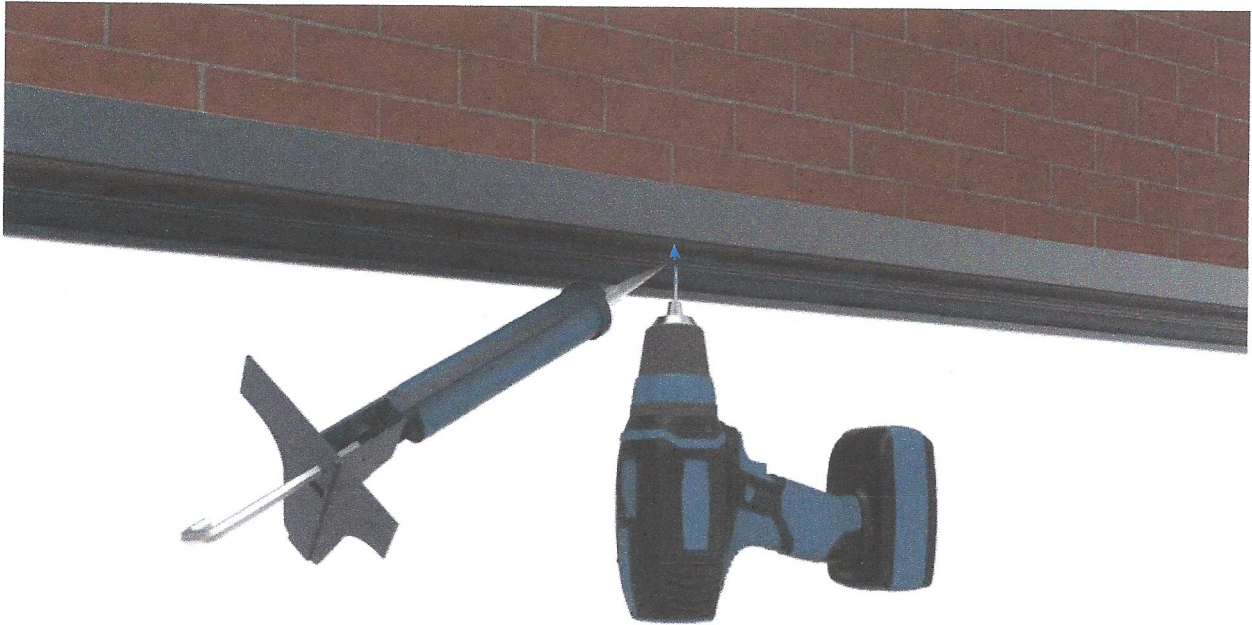

- 7.2** Insert suitable sealant to fixing hole, then screw preferred fixing in place. Repeat process along the bottom track, ensuring fixings are within 900 mm intervals.

Repeat the step 7 on the four profiles of the frame (horizontal and vertical), so as to properly fix it to the wall.

# Installation Guide

- 11.2 Verify that the position of the guides and rollers of each sash is accurate to ensure a proper operation of the window.

Bottom roller position

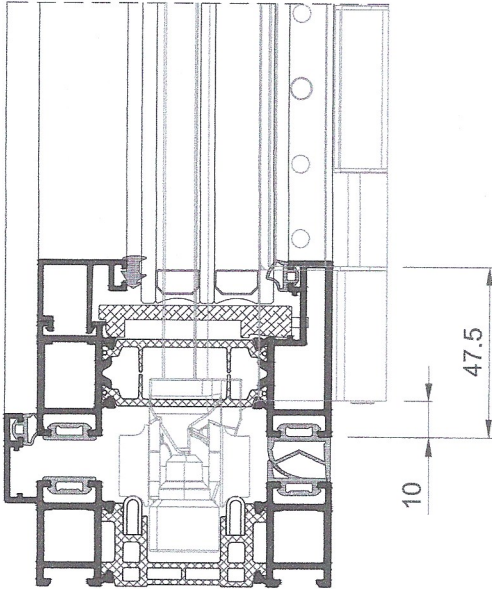

Top guide position

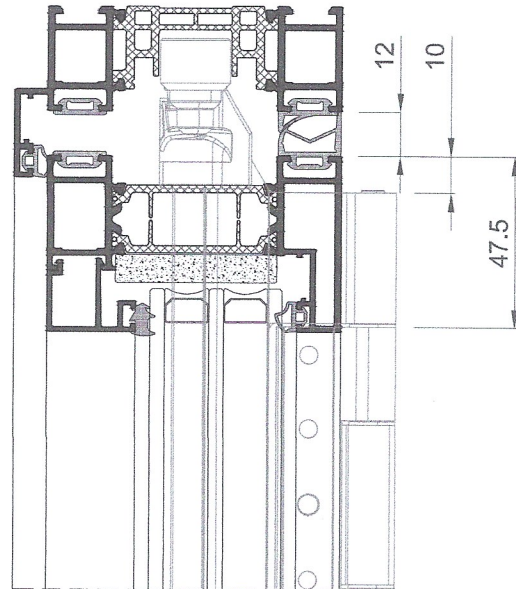

Bottom half roller position

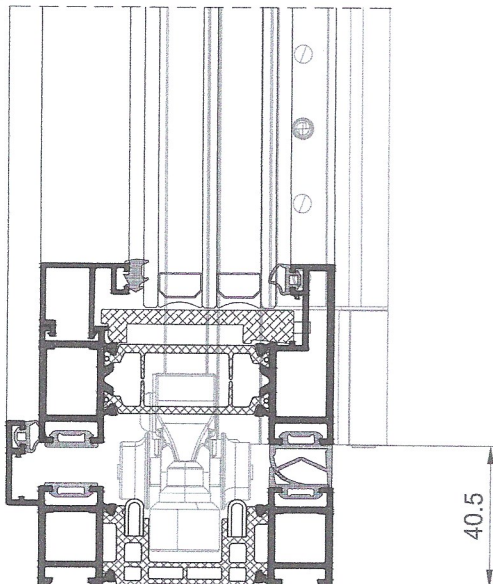

Top half guide position

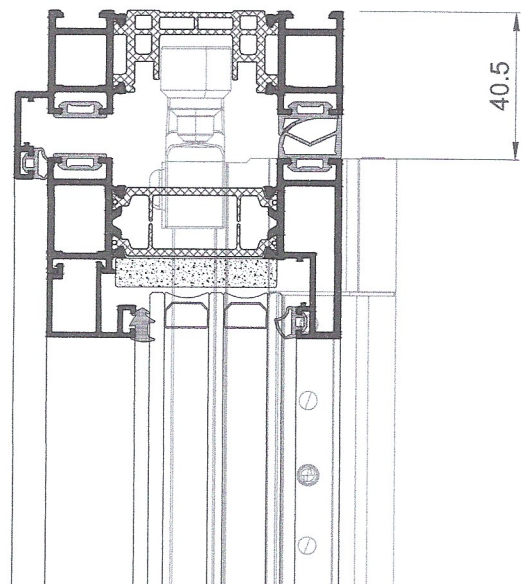

# Installation Guide

**16.2** Glazing packers are required.

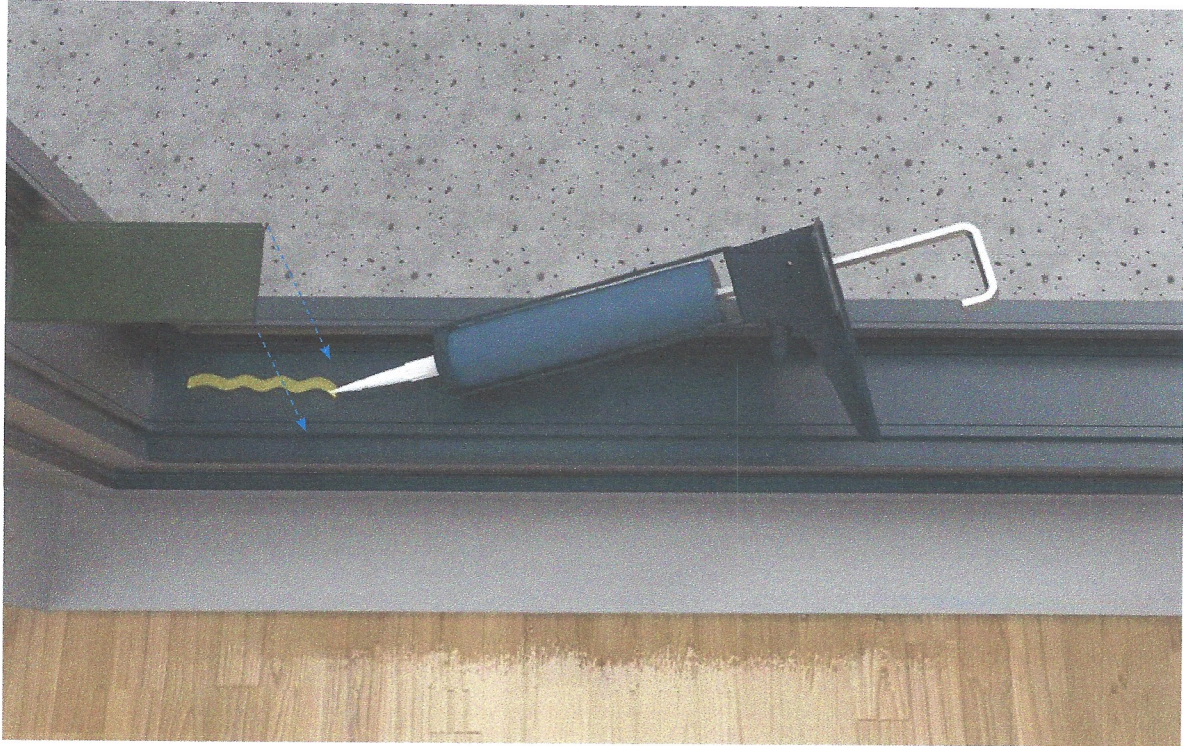

IT IS RECOMMENDED TO POSITION THE GLAZING PACKERS ACCORDING TO THESE CONFIGURATIONS.

The distance between the axis of the wedges and the edge of the glass, will be approx.  $L/10$  (L = glass length).

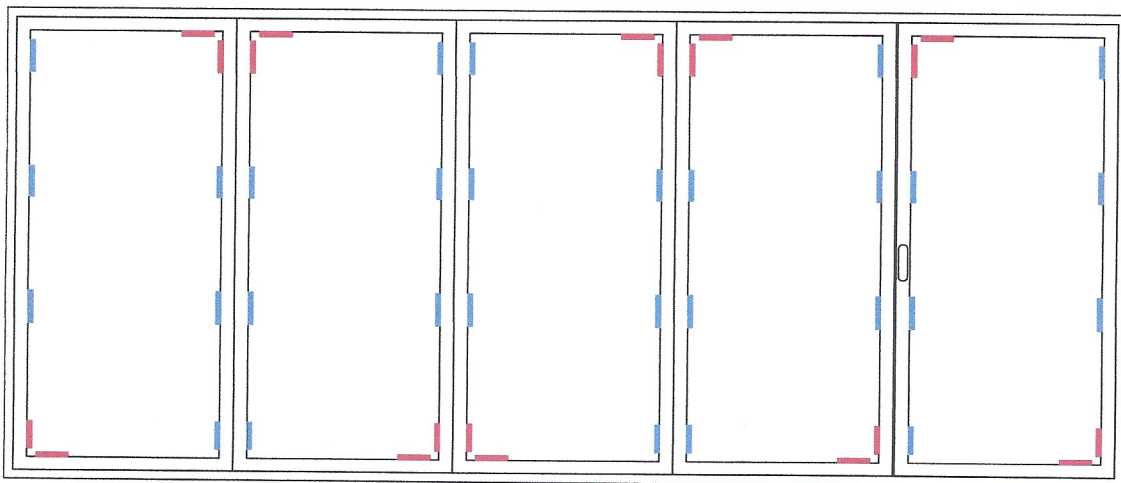

Name of the glazing packers:

- 'Toe and heel'. Load carry packer must be used to keep panels square and level.
- Supporting packers to prevent movement and provide rigidity to panel. Should be installed between all hardware components.

- ! Glazing packers must be placed towards the inside of the bearing points.
- ! The glazing packers must be fitted as shown in the sketch shown above, without adding other glazing packers in different positions.

## Installation Guide

- 16.5 Replace beading, starting with shortest pieces first and tapping into place with a plastic mallet.



! The beads can be clipped onto the frame in both directions as shown in the picture.

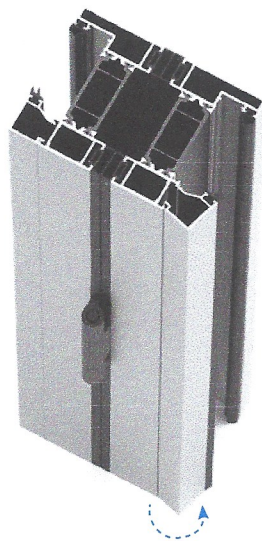

with pre-assembled gasket

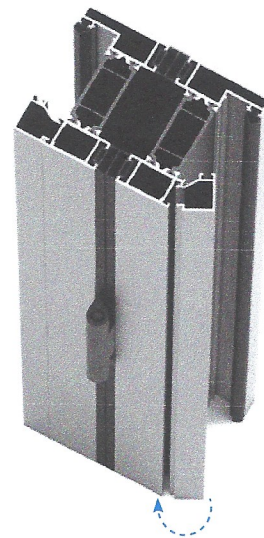

without gasket

- 17 Repeat the 'toe and heeling' process for all panels, ensuring that all door gaps are equal and parallel.